

## Optic fiber array

Auxora's FA have specialty fiber capabilities and customizable V-groove and covers, FA products are tailorable to address your unique specifications including inter-fiber core pitch and precision, channel number, fiber type, and connectors type. Auxora can also develop FA-integrated connectors.

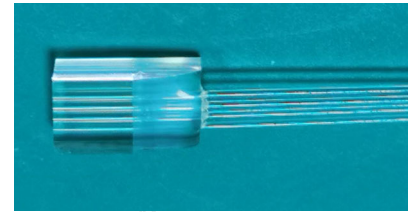

### FEATURES

- Customizable
- High reliability
- Ultra-accurate core pitch position
- Compact design

### APPLICATIONS

- PLC Splitter
- PLC AWGs
- Multichannel Transceiver, QSFP+

### SPECIFICATIONS

| Item                      | Fiber array                             |
|---------------------------|---|
| Channel NO.               | 1/4/8/16/32; customer specify           |
| Core pitch, um            | 250/500; customer specify               |
| Core pitch tolerance, um  | $\pm 0.5 / \pm 0.7 / \pm 1.0$           |
| Polish angle, Deg         | 0/6/8 $\pm 0.3$ ; customer specify      |
| Fiber type                | Single mode fiber / Multi mode fiber/PM |
| Fiber length              | Customized                              |
| Operating Temperature, °C | -40~85                                  |
| Storage Temperature, °C   | -40~85                                  |

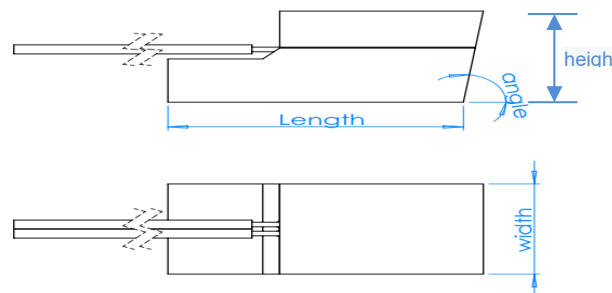

### Ordering Information: (e.g.AFA-043C110)

| AFA- | XX           | X            | X            | X            | X            | X            |
|------|--------------|--------------|--------------|--------------|--------------|--------------|
|      | Channel NO.  | Core pitch   | Polish angle | Fiber type   | Fiber length | Connector    |
|      | 01=1CH       | 1=127um      | A=0°         | 1=SM fiber   | 1=50mm       | 0=NA         |
|      | 02=2CH       | 2=250um      | B=6°         | 2= MM fiber  | 2=100mm      | 1=LC         |
|      | 04=4CH       | 3=500um      | C=8°         | 3=PM fiber   | X=Customized | 2=SC         |
|      | 08=8CH       | 4=750um      | D=42°        | X=Customized |              | 3=FC         |
|      | 16=16CH      | X=Customized | X=Customized |              |              | 4=MPO        |
|      | X=Customized |              |              |              |              | X=Customized |